



# INSTALLATION MANUAL

CLUB 605CSQ

CLUB 625SQ

# CLUB 605CSQ

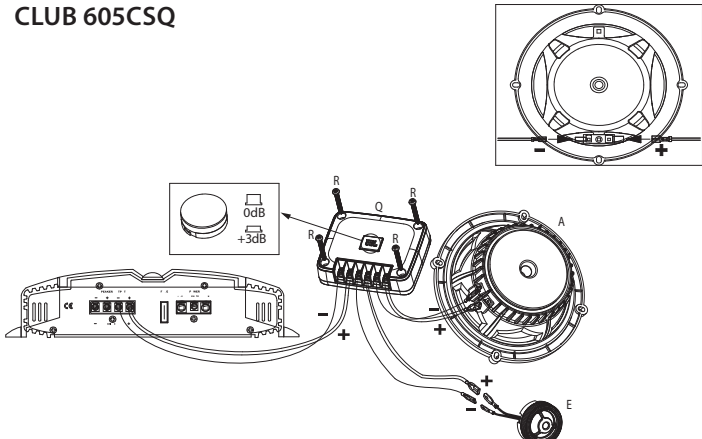

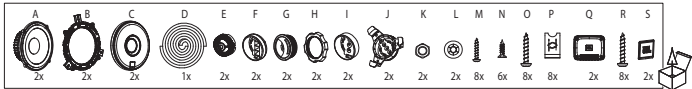
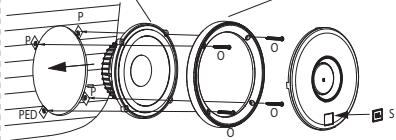
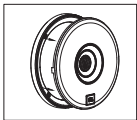
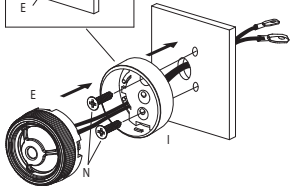
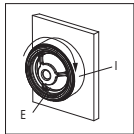

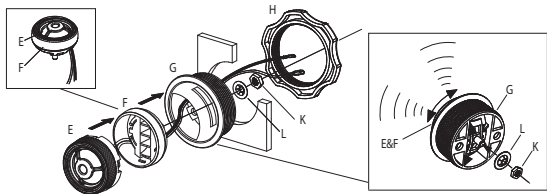
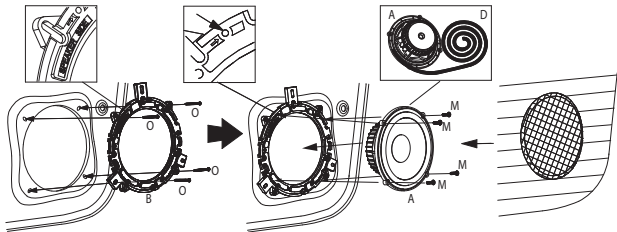

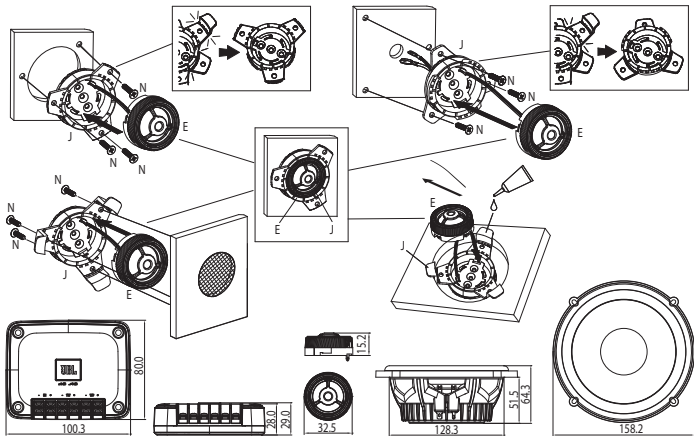

## Specification

- Type: 6-1/2" (160mm) 2-way Component Speaker System, Engineered For Ultimate Sound Quality.
- Power Handling: 95W RMS, 285W peak
- Sensitivity (@ 2.83V): 93dB
- Frequency Response: 48Hz – 21kHz
- Nominal Impedance: 3.0 ohms

## Thiele-Small Parameters

- BL (Tm): 3.776
- DCR (ohms): 2.09
- Mms (g): 13.238
- Sd (cm<sup>2</sup>): 132.73
- Cms (μm/N): 0.536
- Vas (l): 13.3648
- Fs (Hz): 59.7
- Qes: 0.728
- Qms: 8.315
- Qts: 0.670
- Crossover Point: 5 kHz

# CLUB 625SQ

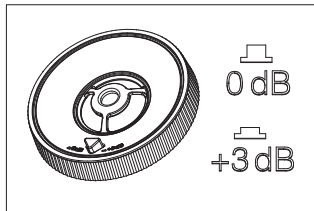
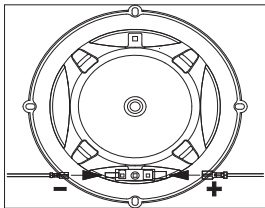

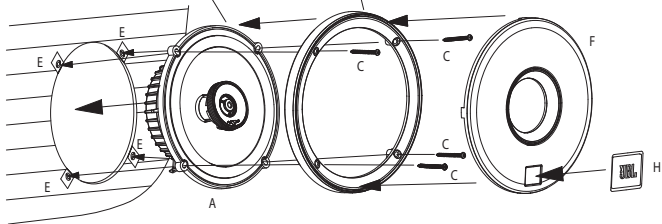
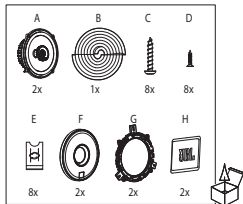
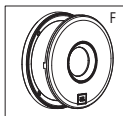



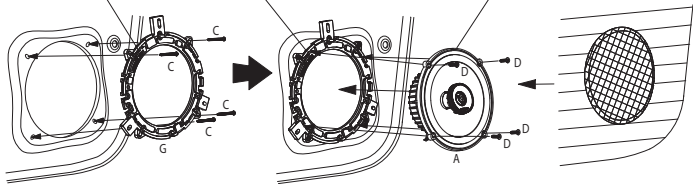
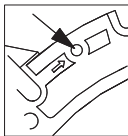
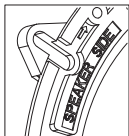

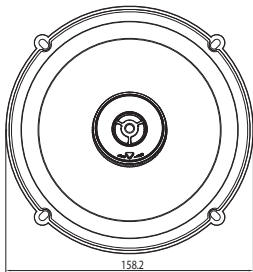
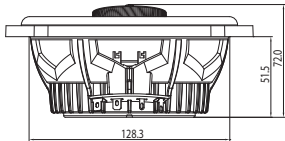

## Specification

- Type: 6-1/2" (160mm) 2-way Car Speaker, Engineered For Ultimate Sound Quality.
- Power Handling: 75W RMS, 225W peak
- Sensitivity (@ 2.83V): 93dB
- Frequency Response: 48Hz – 21kHz
- Nominal Impedance: 3.0 ohms

## Thiele-Small Parameters

- BL (Tm): 3.748
- DCR (ohms): 2.12
- Mms (g): 12.273
- Sd (cm<sup>2</sup>): 132.73
- Cms (μm/N): 0.530
- Vas (l): 13.2162
- Fs (Hz): 62.4
- Qes: 0.724
- Qms: 9.037
- Qts: 0.671
- Crossover Point: 5 kHz



HARMAN International  
Industries, Incorporated, 8500  
Balboa Boulevard, Northridge,  
CA 91329 USA

© 2020 HARMAN International  
Industries, Incorporated.

All rights reserved. JBL is a trademark of HARMAN International Industries, Incorporated, registered in the United States and/or other countries.

Features, specifications and appearance are subject to change without notice.